

**MINISTRY OF FINANCE  
CUSTOMS AND EXCISE DIVISION**

**NOTICE TO IMPORTERS NO. 2 OF 2021**

**SUBJECT: UPDATE ON ASYCUDA 4.2.2**

In an effort to assist with the current challenges faced by Importers with the recent introduction of the Asycuda 4.2.2 system, the Comptroller of Customs and Excise advises of the following:

1. Importers shall direct all queries or questions to any member of the Functional Team or Technical Team at the email addresses listed hereunder. Screenshot of errors should also be included and a telephone contact number provided.

**Functional Team:**

- [donnie.singh@customs.gov.tt](mailto:donnie.singh@customs.gov.tt)
- [deonyse.williams@customs.gov.tt](mailto:deonyse.williams@customs.gov.tt)
- [latifa.edoo-juman@customs.gov.tt](mailto:latifa.edoo-juman@customs.gov.tt)
- [rowena.maitland-jack@customs.gov.tt](mailto:rowena.maitland-jack@customs.gov.tt)
- [sandra.regis@customs.gov.tt](mailto:sandra.regis@customs.gov.tt)
- [vaienda.wickham@customs.gov.tt](mailto:vaienda.wickham@customs.gov.tt)
- [vaidy.heeralal@customs.gov.tt](mailto:vaidy.heeralal@customs.gov.tt)

**Technical Team:**

- [kior.pollonais@customs.gov.tt](mailto:kior.pollonais@customs.gov.tt)
- [jameel.karim@customs.gov.tt](mailto:jameel.karim@customs.gov.tt)
- [vishal.danraj@customs.gov.tt](mailto:vishal.danraj@customs.gov.tt)
- [ansar.mohammed@customs.gov.tt](mailto:ansar.mohammed@customs.gov.tt)

2. It is important to note that an updated version of **Java 8 and above** is required to be downloaded to your computer in order to access the Asycuda system. The following steps are then required:

- On the **Java Control Panel** select the **Security** tab → **Edit Site List** → Select **Add** → Enter the following link In the Exception Site List <http://asycuda.customs.gov.tt:8080/> →click **OK** → continue to the Customs Border Control System (CBCS) page and select the green Production Server tab to enter the system.

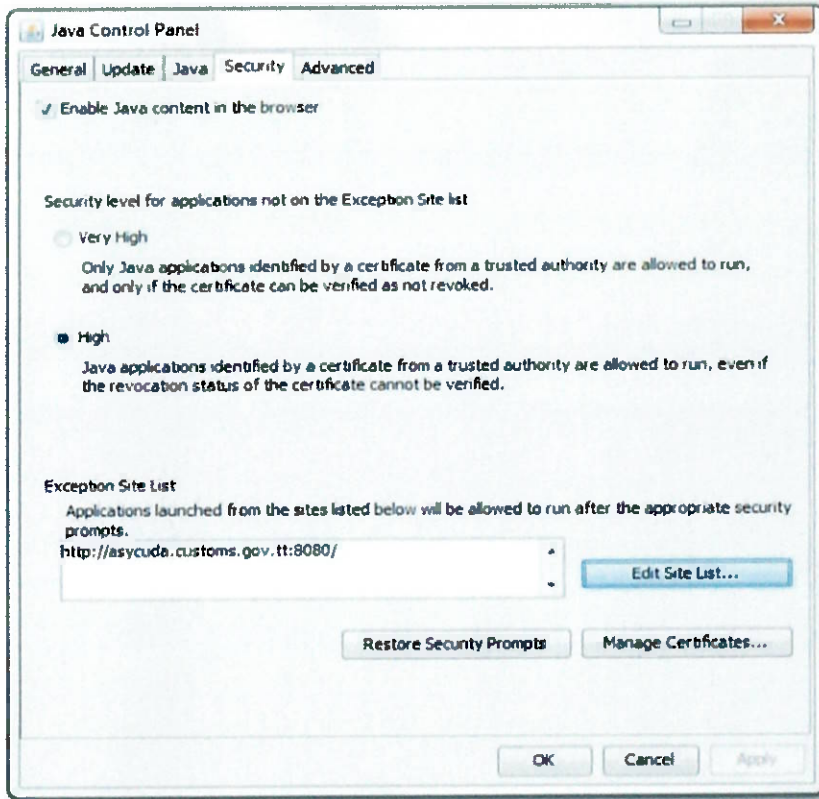

The Comptroller remains committed to maintaining compliant trade and assures all Importers that the Division continues to work assiduously to ensure a smooth transition to the Asycuda 4.2.2 system.

Importers are to be guided accordingly.

  
.....  
Comptroller of Customs & Excise  
Custom House, Port of Spain  
Ref. No: C&E 11/1/1  
Date: 07/01/2021

